

**SAKURA®**



**Precision Air Condition**



# ***Precision Air Condition***

Sakura , the worldly leading provider of critical power supply and cooling systems, who specialized in manufacturing precision air conditioner, UPS uninterruptible power supply, VRLA battery, STS static transfer switch, intelligent power distribution system and SPD surge protection device.

we have more than 30 years' R&D and manufacturing experience in server room equipment field, depends on world class labs and inspection and production equipment, not only can provides specialized products for meeting the exact requirement of user's job site, but also provides a perfect total solution for server room, rely on our complete production line of critical equipment used in server room.

Our professional system engineer and international sales and service team are all through the world in Mexico, Russia, Pakistan, China, Philippines, Singapore, Kazakhstan, to ensure we can provides 24 hours service to more than fifty countries around the world.





➡ High quality control component

It strictly complies with CE and IEC standards and is empowered with advanced electric control technology and able to work under a power source of 380V±20%. In addition, it is installed with a power supply protection module, enabling it to make a selection of protective value in a range of 380V±50%. When voltage goes beyond the selected range, it will automatically protect the unit. While the voltage becomes normal, it will automatically restart the unit.

➡ Filter

Air filter under EU4 standard which is metallic bracket , filtering the dust and particulate effectively by air circulation , then purifying the air environment of telecom room.

➡ Evaporator

An efficient evaporator made from quality material with advanced professional technology and featuring large heat exchange area and the realization of higher sensible heat factor of precision air conditioning unit.

➡ Scroll Compressor

The core power of the unit is from Copeland hermetic scroll compressor that guarantees the high efficiency, low noise and long life of the unit.

➡ Expansion Valve

Expansion valve adopts advanced thermal expansion valves with strong reliability and stability and can precisely control the supply of refrigerant. In order to achieve the reduction of energy consumption for refrigeration equipment, we employ advanced electronic expansion valves in high-performance precision air conditioning units to realize less energy consumption.

➡ Indoor blower fan

A blow fan adopts direct drive centrifugal fan with backward curved blades, the range of static pressure can be adjusted from 0 to 400pa, realizing the continuous operation of 365 days\* 24 hours, 10 years' average life. The high-performance unit employ energy-saving EC fan controlled by 0-10V signal,DC driven and stepless speed regulation,which is more excellent than traditional fan in energy-saving filed.

➡ Humidifier

An internationally advanced electrode steam humidification system under which the amount of humidification and water inflow and outflow are all controlled by computer, the auto cleaning program for the humidifier cylinder ensure normal humidification efficiency of the cylinder.

➡ Heater

An electric heater with perfect overheat protection function and ionization resistance, able to meet environmental requirements of the small heat-load machine rooms for base stations in cold arctic-alpine area.

➡ Cabinet

With unique frame design and black steel framework demonstrating consummate production technology, professional design and elegant appearance, the cabinet guarantees the safety of the unit under any transport condition and operating environment.

➡ Condenser

With an enclosure of anti-corrosion alloy that ensures service life and appearance of the condenser, an external rotor axial flow fan that is elaborately designed and able to satisfy the environmental protection requirements on noise, and a fan speed regulator that controls the rotating speed under different temperature and ensures sound operating effect and energy saving.

Microprocessor control

The control system of the unit adopts advanced 32 bits microprocessor that provides more accurate and convenient system monitoring , programming and alarm record. Under normal range of working temperature and humidity, the accuracy of temperature control is at ±0.2 and that of humidity control ±2%. The control panel of high configuration unit can choose the big touch screen with 1/4 VGA resolution.

Various kinds of Internet centralized monitoring modes

Through Internet monitoring network, a real-time long-distance monitoring on air conditioning unit can be realized. This system supports various kinds of networks, such as: homenet, telenet, building automation system and power and environment centralized monitoring network.

Product Model Name Convention

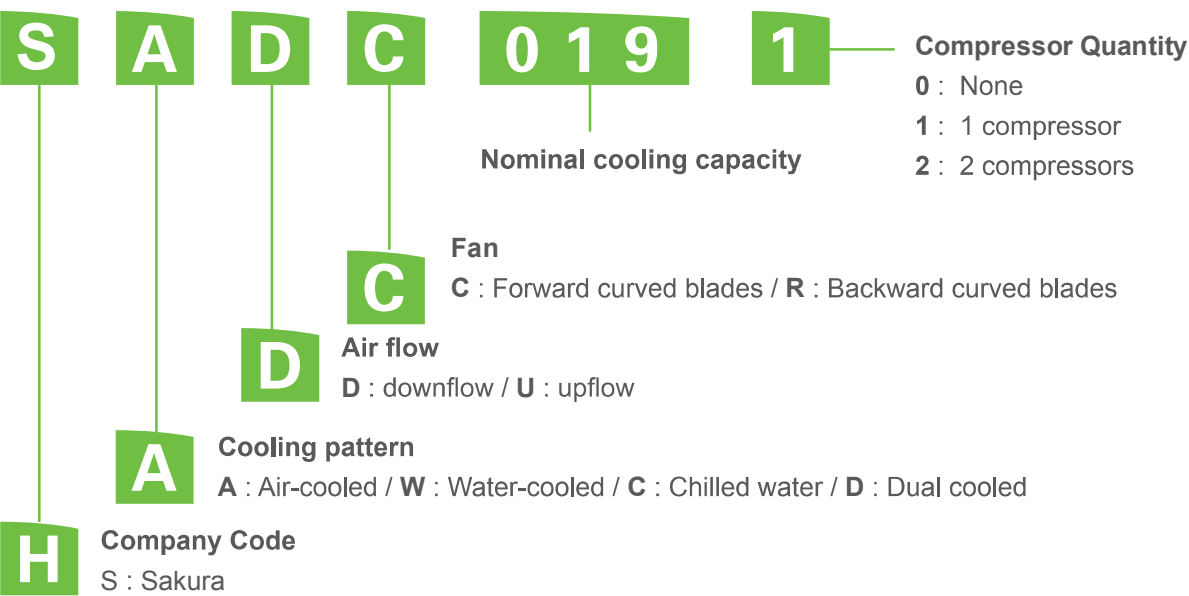

Flow / displacement

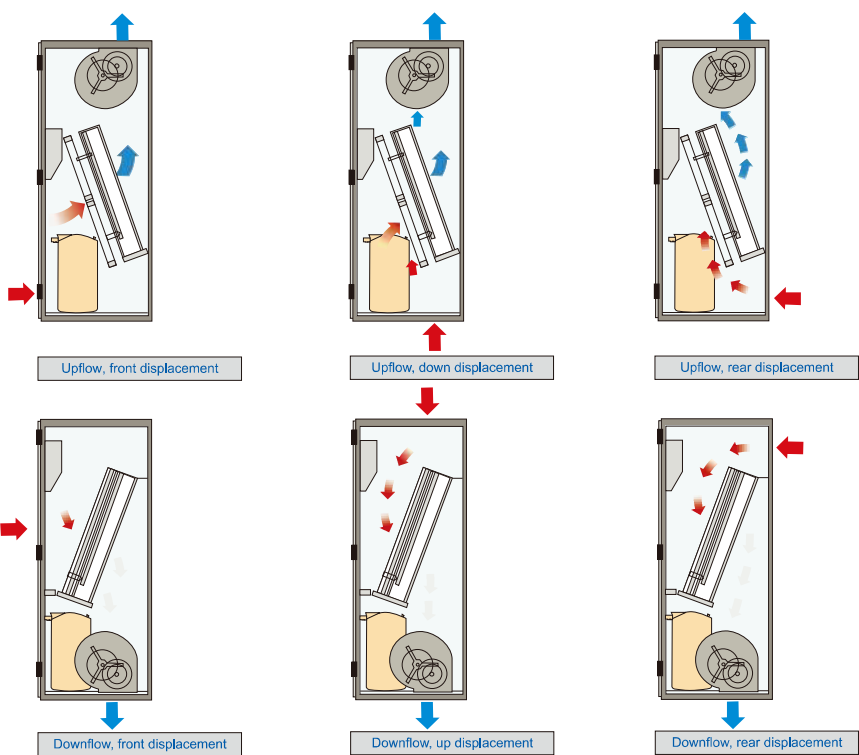



## Technical Data for Air Cooled DX Units (II)

Model : SADR/SAUR		0200	0251	0261	0271	0301	0351	0401	0451
Cooling capacity(1)	kw	18. 2	23. 2	26. 8	27. 3	31. 5	35. 6	41. 2	44
Air flow	m <sup>3</sup> /h	5720	7050	7280	8500	9000	10000	11000	13000
EER		3. 72	3. 60	3. 60	3. 75	3. 71	3. 71	3. 71	3. 68
SHR		0. 98	0. 98	0. 92	0. 98	0. 99	0. 98	0. 97	0. 95
Compressor									
Type	Scroll								
Capacity	kw	5. 2	5. 5	5. 9	6. 2	7. 4	8. 3	9. 3	10. 1
Quantity	nr	1	1	1	1	1	1	1	1
Finned coil evaporator									
Frontal surface	m <sup>2</sup>	0. 8	0. 8	0. 8	1. 4	1. 4	1. 4	1. 7	1. 7
Geometry	mm	25×21. 65							
Type of fins	Hydrophilic								
Fin pitch	mm	1. 8							
Fan section									
Type	DC Centrifugal EC fan								
Quantity	nr	1	1	1	1	1	1	2	2
Absorbed current	A	2. 5	2. 5	2. 8	3. 2	3. 5	4. 1	4. 4	4. 9
Absorbed power	W	1050	1100	1200	1300	1320	2000	2150	2400
AESP Max Speed(2)	Pa	360	360	360	380	380	355	355	355
Air filter									
Efficiency	EU4								
Overall surface	m <sup>2</sup>	5. 8	5. 8	5. 8	6. 5	6. 5	6. 5	7. 8	7. 8
Fire resistance class	1								
Electrical heaters									
Total heating capacity	kw	4	5	5	5	5	8	8	8
Quantity	nr	2	2	2	2	2	2	2	2
Material	PTC								
Humidifier									
Capacity	Kg/h	3-8	8-13	8-13	8-13	8-13	8-13	8-13	8-13
Absorbed power	kw	6	6	6	6	6	6	6	6
Dimension&Weight									
Height	mm	1900	1998	1998	1998	1998	1998	1998	1998
Length	mm	750	1000	1000	1000	1000	1000	1750	1750
Depth	mm	660	795	795	795	795	795	795	795
Weight	kg	210	385	393	450	490	590	595	610
Sound level									
Sound pressure level	dB (A)	52	53	53	55	56. 5	58	60	60

# SAKURA®

**SAKURA COMPANY LIMITED**

Tel: (81)45-949-8550 Fax: (81)45-1887-2994 E-mail: [mail@sakuraaircon.com](mailto:mail@sakuraaircon.com) URL: [www.sakuraaircon.com](http://www.sakuraaircon.com)  
16-14, Takara, Yokohama, Kanagawa, 221-0023, Japan